

axigen MAIL SERVER

EASY. SECURE. POWERFUL. MESSAGING



Business Edition

A complete messaging solution, AXIGEN Mail Server Business Edition provides an answer to all the challenges of a dynamic business environment. Designed for Small and Medium Businesses, this edition makes administration and user access easier, offering full-scale security features. Additionally, the localized WebMail module enables full access to one's email, regardless of location.

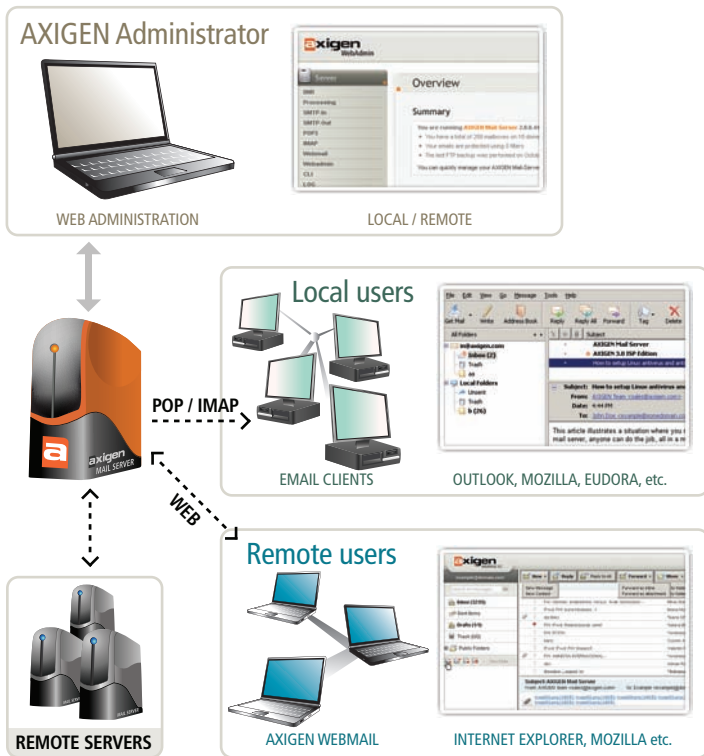

EASY MANAGEMENT and FIRsT SUPPORT

- ▶ **Fast Installation in less than 15 min**
- ▶ Flexible Administration, Secure Remote Operation - Webadmin GUI
- ▶ Advanced Reporting Engine (more than 100 customized reports)
- ▶ Automatic Data Migration (users and domains)
- ▶ **24x7 FIRsT (Free, Immediate Response Time) Support**

SECURE BY AXIGEN GrowSecure™ ARCHITECTURE

- ▶ Professional Encryption / Authentication
- ▶ Smart Filtering System - with more than **15 Antiviruses / AntiSpam / Antimpersonation**
- ▶ Message Acceptance Policies
 - ▶ Reject mails according to company's AntiSpam policies
 - ▶ Sender validation (SPF) / IP validation (Domain Keys compliant)
 - ▶ Accept mail from trusted sources
- ▶ Built-in SMTP Router

POWERFUL TECHNOLOGY

- ▶ **AXIGEN SmartProcessing™** delivery
 - ▶ Impressive processing speed
 - ▶ Independent processing threads
 - ▶ Dynamic configuration "On the fly"
 - ▶ Flexible configuration (per server / domain / user)
 - ▶ Advanced forwarding options (SIEVE filtering)
- ▶ **AXIGEN UltraStorage™** method
 - ▶ Optimal storage (avoid redundancy, optimized queue processing, etc)
 - ▶ Online back-up and restore on the fly
- ▶ Automated operations - script based (CLI - command line interface)
- ▶ Skinable WebMail that allows dynamic localization
- ▶ SDK (Software Development Kit) for integration with third party applications

Main components included:

Email (SMTP) Server	✓
POP3 / IMAP Server	✓
WebMail Server	✓
List Server	✓
WebAdmin Console	✓
Automatic Migration	✓
AntiVirus / AntiSpam Support for over 15 applications	✓
FIRsT Support (Technical Support 24x7 & Software Maintenance)*	✓

*) Free for one year

HOW MUCH AXIGEN CAN DO FOR YOU



**"All-in-one" integrated mail server
with Technical Support**

AXIGEN INTEGRATED SOLUTION

vs.

EQUIVALENT OPEN SOURCE APPLICATIONS

Sendmail / Qmail / Postfix / Exim • Cyrus / Dovecot / Courier / VPOP3 • Apache + PHP + Perl + SquirrelMail / SQWebMail / Horde / Webmin / web-cyradm / vMail.Admin / QmailAdmin • MBOX / MailDir / Cyrus • Squirrelmail Config Utility • SysLog / Syslog-ng / Metalog • MailMan / EzMLM / Ecartis • RRUtil / MRTG / Cacti • PAM / saslauthd / courier-authdaemon

SMALL AND MEDIUM BUSINESSES

Try out an integrated email server solution designed to be fast, reliable and secure. Discover the benefits provided by the AXIGEN innovative multiplatform server technology.

axigen
MAIL SERVER

FIRST SUPPORT IS YOURS FROM THE START



24x7 Free, Immediate Response Time Support

- ▶ Human response time within average 3h by email
- ▶ Extensive technical support - including OS and connectivity troubleshooting
- ▶ Support in local language by local partners
- ▶ Multiple Additional Resources (KnowledgeBase, Online Documentation, Forum, Newsletter, etc)

Also you may choose CUSTOMIZED SUPPORT to have:

- ▶ Phone Support
- ▶ FREE call-back hotline
- ▶ Monthly service report
- ▶ Implementation: support and training

Flexible licensing programs

- ▶ "Pay for what you use" Licensing Policy - tailored to customer revenue stream with volume cost savings
- ▶ OS independent licensing - you can switch between OS-es with no additional charge
- ▶ Tailored solutions for educational and government institutions

Strong customer retention policy

- ▶ Perpetual License - it has a life time usage period
- ▶ Low operating costs - 20% software maintenance fee per year
- ▶ Easy license upgrade and update procedures
- ▶ Migration tools and services available

Customer Testimonials

“ Axigen is one of the easiest, flexible and most dependable mail servers on the market. It is by far the most outstanding product of it's kind I have seen! ”

Dwayne Dirk
Custom Security Systems, USA

“ The support service is really awesome, the best I have ever experienced from any company. You get an answer within the hour, even when you are a non-paying customer. I even got replies in weekends in the middle of the night. Really amazing! ”

Nick Snels
Jobaria, Belgium

CONTACT INFO

GECAD TECHNOLOGIES

10A DIMITRIE POMPEI BLVD., 020337 BUCHAREST 2,
ROMANIA

Tel: +40 21-303 20 80

Fax: +40 21-303 20 81

Email: sales@axigen.com

www.axigen.com



ASK FOR EVALUATION

All AXIGEN product kits can be downloaded as evaluation versions for 30 days

- All features enabled
- UNLIMITED Users
- UNLIMITED Domains
- FIRsT Support included



www.axigen.com/download/

MAIN SERVICES

- Email (SMTP) Server with ESMTP Support
- POP3 Server / Remote POP Access
- IMAP Server
- Webmail Server - multilanguage / skinable
- Log Server / List Server
- Reporting Engine with over 100 reports
- **Back-up and Restore**
- Automatic Migration Utility

ADMINISTRATION

- Remote Server Administration (Web Based)
- Command Line Interface
- Configuration File
- **Secure Password Enforcement**

USER RELATED

- Out-of-office auto-replies
- Message delivery rules (Outlook like)
- Forwarders and Account Aliases
- Public Folders
- Address Book

ANTIVIRUS / ANTISPAM

- Antivirus & AntiSpam Support (Kaspersky, BitDefender, Sophos, F-Prot, DrWeb, Symantec, F-Secure, Avast, eTrust, Norman, Panda, McAfee, TrendMicro, Nod32, ClamAV and SpamAssasin)
- Support for combining multiple scanners

SECURITY

- Encryption / Authentication
- Firewall - application level (on SMTP, POP3, IMAP and HTTP)
- Message acceptance policies at SMTP-connection level
- Sender Validation (SPF)
- Domain Validation (DK compliant)
- Server, domain and user level filters
- Routing Policies

ARCHITECTURE

- MPA (Multi Platform Architecture)
- Multi-threaded mail engine
- Allow concurrent user access
- RFC Compliance
- Single storage of emails with multiple recipients

Operating Systems

Linux (specific packages: RedHat Enterprise, Fedora, CentOS, SuSE, Gentoo, Novell, Ubuntu, Debian, Mandriva, Slackware), FreeBSD, NetBSD, OpenBSD and Solaris